

**Y-STRAINER**  
Size DN50-DN600 PN16/PN25  
**FIG · 7103-PN16 , FIG · 7107-PN25**

**Specification**

- BSPT blowoff outlet on cover. Blowoff outlets are finished with plugs.
- Screens are perforated 304 stainless steel with spot welded seam.
- Recessed seat in body assures accurate screen alignment.
- With flange EN1092-2 PN16/PN25, other types are available.
- Face to face dimension in accordance with DIN3202 series F1.

**Working Pressure**

- 16bar for Size DN50 to DN600
- 25bar for Size DN50 to DN300

**Working Temperature**

- -10°C to 120°C

**Corrosion Protection**

- Internally and externally liquid epoxy painted or fusion bonded epoxy powder coated (FBE).

**Material Specification**

Part Name	Materials	EN Spec.	ASTM Spec.	
Body	7103	Cast Iron	EN-JL1040	ASTM A126 Class B
	7107	Ductile Iron	EN-JS1050	ASTM A536 65-45-12
Cover	7103	Cast Iron	EN-JL1040	ASTM A126 Class B
	7107	Ductile Iron	EN-JS1050	ASTM A536 65-45-12
Screen	Stainless Steel	BS970 304S15	AISI 304	
Gasket	Teflon / EPDM/Graphite	Commercial	Commercial	
Plug	7103	Cast Iron	EN-JL1040	ASTM A126 Class B
	7107	Ductile Iron	EN-JS1050	ASTMA536 65-45-12

**Standard Screens**

Size	Hole Dia.	Free Flow Area
DN50 to 80	1.5mm	33%
DN100 to 600	3.0mm	40%

**Dimensions (mm)**

Size	50	65	80	100	125	150	200	250	300	350	400	450	500	600
L	230	290	310	350	400	480	600	730	850	980	1100	1200	1250	1450
H	145	170	195	233	276	318	370	518	545	755	827	930	980	1170
Plug	1/2"	1"	1"	1"	1-1/4"	1-1/2"	1-1/2"	2"	2"	2"	2"	2"	2"	2"
Weight (kg)	10	14.5	19	19	40	62	109	197	253	458	556	627	780	1080

**Drawing and Picture**

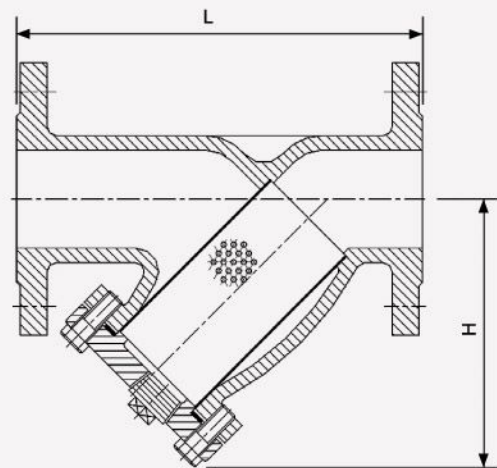

**Notes:** Design and material are subject to change without notice.